

INDICATIVE IMAGERY

Opportunity to
combine
units 2 & 4

11,912 sq.ft
(1,107 sq.m)

TO BE REFURBISHED

TO LET Industrial/Warehouse Unit
6,044 sq.ft (561 sq.m)

Unit 2, Little John's Lane, Reading, Berkshire, RG30 1RA

- Prominent location surrounded by trade/retail
- Excellent loading/unloading area with parking
- Close to the M4
- Secure fenced yard/parking

LCP
part of MCore

**01384
400123**

searchlcp.co.uk



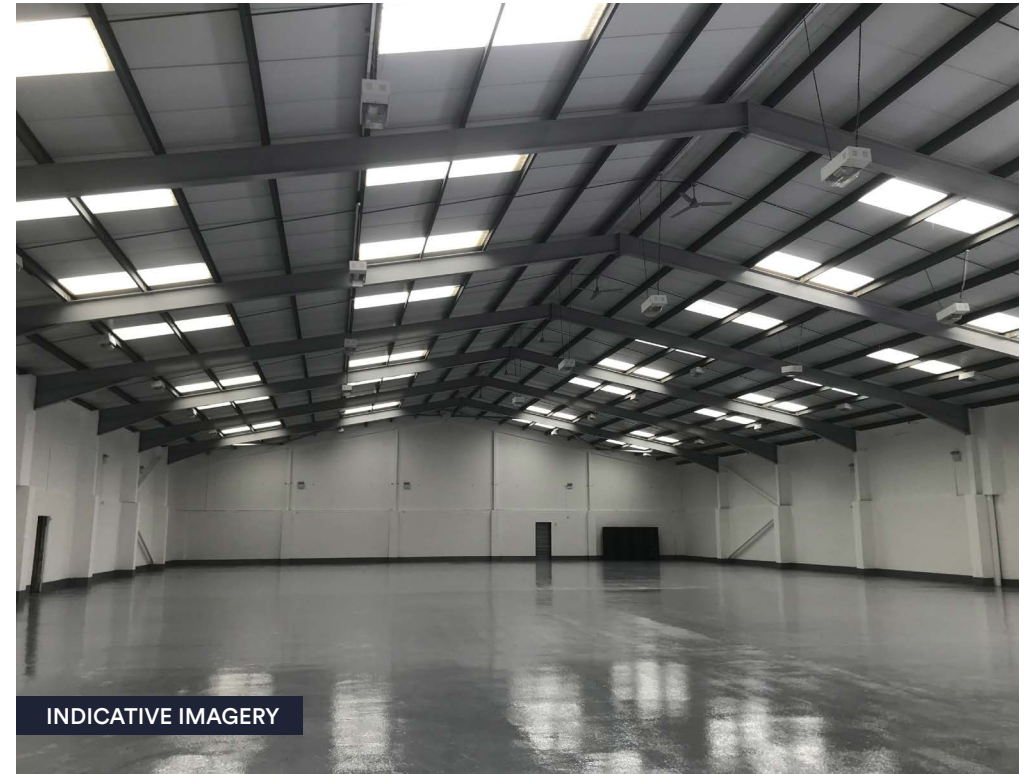
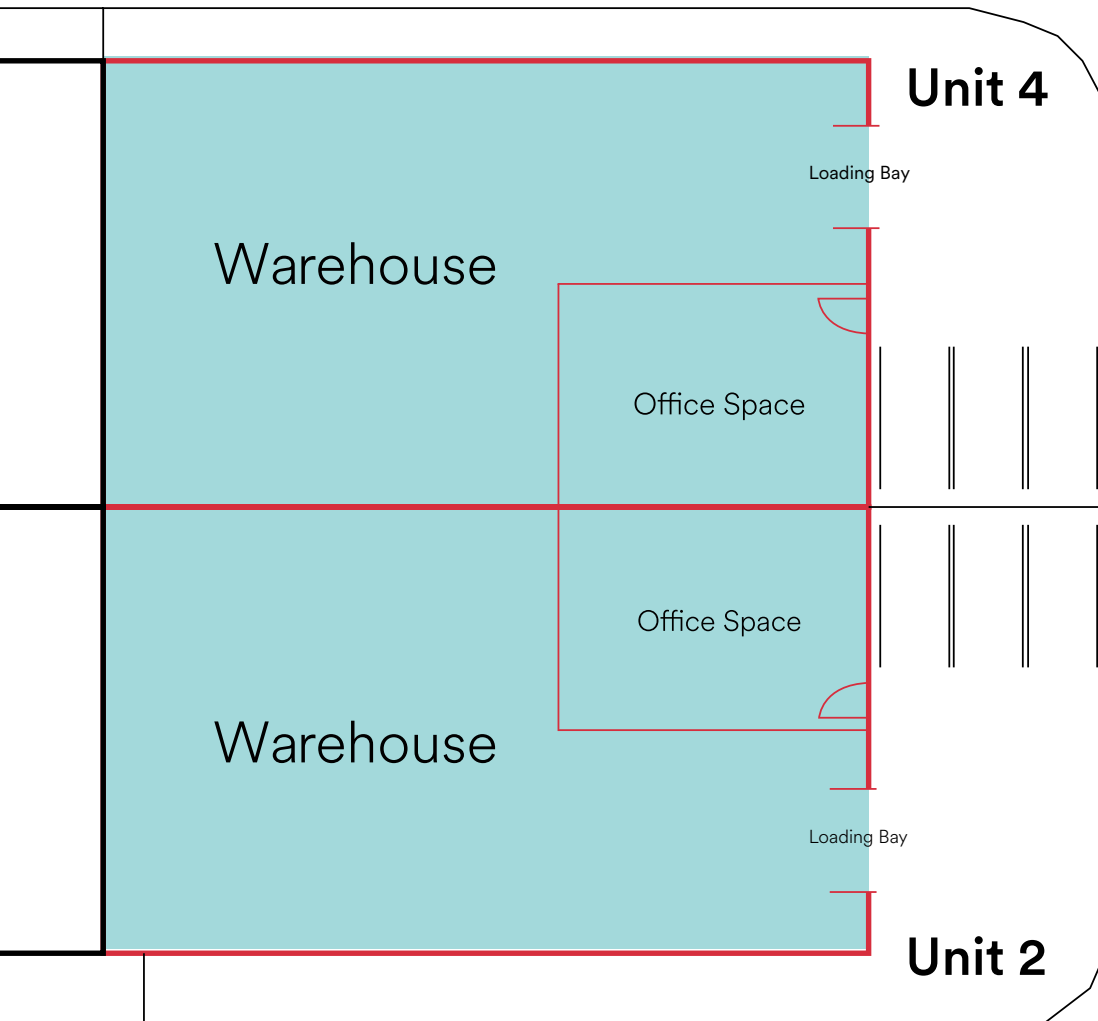

Unit 2, Little John’s Lane, Reading, Berkshire, RG30 1RA

Areas (Approx. Gross Internal)

Warehouse/Industrial	4,550 sq.ft	423 q.m
Ground floor offices	747 sq.ft	69 sq.m
First floor offices	747 sq.ft	69 sq.m
Total	6,044 sq.ft	(561 sq.m)

Amenities:

- Ground and First floor offices with air conditioning
- Warehouse with minimum eaves height 5.5m rising to 7m
- Secure fenced yard/parking area

Rent

£79,000 p.a.

Business Rates

Rateable Value £35,000
Rates payable £18,200
Reading Borough Council

Insurance

The Landlord will insure the premises the premium to be recovered from the tenant.

Energy Performance

EPC D:81. Further information available upon request.

Planning

All interested parties are to make their own specific enquiries directly with the Local Planning Authority as to their intended use.

Legal and Surveyor Costs

Each party will be responsible for their own legal and surveyors costs incurred with the proposed transaction.

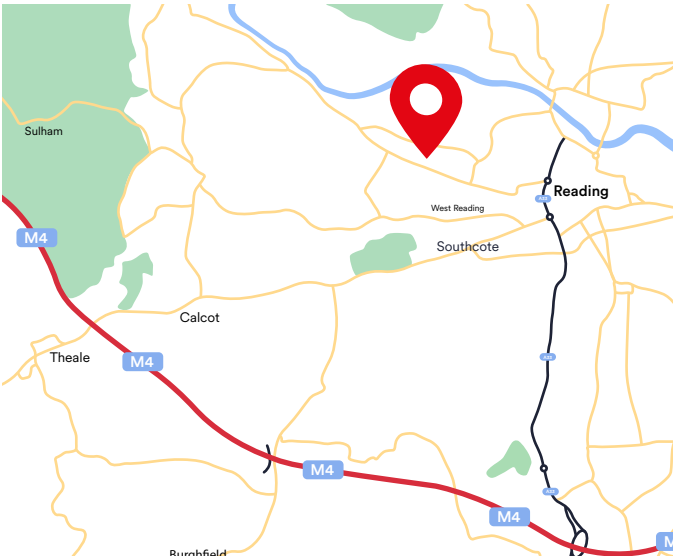

Location - RG30 1RA

An established industrial estate located approximately 1.5 miles north west of Reading town centre. Access to the M4 is via the A33 dual carriageway which links the town centre to J11 or via Tilehurst to J12.

Local Distances (Approx.)

Reading	2.1 Miles
Calcot	3.3 Miles
Theale	4.5 Miles
Earley	5.8 Miles
Woodley	5.8 Miles
Newbury	19.7 Miles
Slough	23.4 Miles
Oxford	26.4 Miles

Viewing

Strictly via prior appointment with the appointed agents

WALTERS

COMMERCIAL

07764 230561
walterscommercial.co.uk

Shaun Walters

07764 230561

swalters@walterscommercial.co.uk

LCP

part of MCore

01384
400123

searchlcp.co.uk



Claudia Gasparro
07831 338014
CGasparro@lcpproperties.co.uk

MISREPRESENTATION ACT, 1967 London & Cambridge Properties Limited (Company Number 02895002) the registered office of which is at LCP House, Pensnett Estate, Kingswinford, West Midlands DY6 7NA its subsidiaries (as defined in section 1156 of the Companies Act 2006) associated companies and employees ("we") give notice that: Whilst these particulars are believed to be correct no guarantee or warranty is given, or implied therein, nor do they form any part of a contract. [We do our best to ensure all information in this brochure is accurate. If you find any inaccurate information, please let us know and where appropriate, we will correct it.] We make no representation that information is accurate and up to date or complete. We accept no liability for any loss or damage caused by inaccurate information. [This brochure gives a large amount of [statistical] information and there will inevitably be errors in it]. Intending purchasers or tenants should not rely on the particulars in this brochure as statements or representations of fact but should satisfy themselves by inspection or otherwise as to the correctness of each of them. We provide this brochure free of charge and on the basis of no liability for the information given. In no event shall we be liable to you for any direct or indirect or consequential loss, loss of profit, revenue or goodwill arising from your use of the information contained herein. All terms implied by law are excluded to the fullest extent permitted by law. No person in our employment has any authority to make or give any representation or warranty whatsoever in relation to the property. SUBJECT TO CONTRACT. We recommend that legal advice is taken on all documentation before entering into a contract. You should be aware that the Code of Practice on Commercial Leases in England and Wales strongly recommends you seek professional advice from a qualified surveyor, solicitor or licensed conveyancer before agreeing or signing a business tenancy agreement. The Code is available through professional institutions and trade associations or through the website <https://www.rics.org/uk/upholding-professional-standards/sector-standards/real-estate/code-for-leasing-business-premises-1st-edition/>. LCP's privacy notices that apply to its use of your personal information are at www.lcpgroup.co.uk/policies. The privacy notice that applies to you will depend on the nature of your relationship with LCP, and in some cases more than one may apply to you. LCP's privacy policy giving a high level overview of how LCP approaches data protection and your personal information can be found at www.lcpproperties.co.uk/uploads/files/LCP-Privacy-Web-and-Data-Policy-May-2018.pdf.